

Обувка Elmark кабелна тип гилза калайдисана 6 мм², GTY

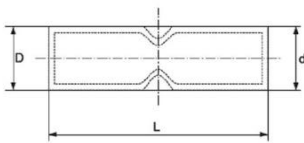



Standard: EN 61 238-1



Connection tubes - GTY type

Copper pipes with galvanic tin coating, used for joining of copper rigid or multicore conductors with different sections. The assembling is made by mechanical pressing with crimping tool.

Technical data:

- Material: copper alloy
- Coating: tin
- Application: general

Type	Length L (mm)	Outer diameter D (mm)	Inner diameter d (mm)	Cable (mm ²)	Packing / Box (pcs)	Catalogue number
GTY-4	20	5	3	4	1000 / 16000	59213
GTY-6	25	5.3	3.7	6	500 / 1500 / 12000	59201
GTY-10	30	6.3	4.5	10	500 / 1500 / 12000	59202
GTY-16	35	7.5	5.7	16	100 / 200 / 4800	59203
GTY-25	40	9	7.2	25	100 / 500 / 2000	59204
GTY-35	45	10.8	8.5	35	100 / 200 / 1600	59205
GTY-50	50	12.5	9.8	50	20 / 200 / 1600	59206
GTY-70	55	14.5	11.5	70	10 / 100 / 800	59207
GTY-95	60	17	13.7	95	10 / 80 / 640	59208
GTY-120	65	19	15	120	10 / 60 / 480	59209
GTY-150	70	21	16.7	150	10 / 50 / 400	59210
GTY-185	75	23	18.5	185	10 / 40 / 320	59211
GTY-240	80	26	21	240	10 / 30 / 240	59212

Продукт: [Обувка Elmark кабелна тип гилза калайдисана 6 мм², GTY](#)

Категория: [Кабелни обувки и накрайници](#)

Бранд: [Elmark](#)

Категория бранд: [Обувка Elmark](#)